

**A single PDT1200 high-security bollard withstands impact from a 7500KG truck travelling at 80 km/h. After impact, the bollard remains operational and continues to ensure security of the access point.**

The PDT1200 high-security bollard is designed to control the access to sensitive installations and protects them from terrorist or vehicle born attacks. Certification PAS68:2010 Bollard V/7500(N3)/80/90:7.1/0.0\* The crash-tests have proven the resilience and high-level of security of the PDT1200 bollard, which remains operational even after various ramming attempts by truck.

## PDT1200 SYSTEM NOW AVAILABLE AS A PRE-FABRICATED COMPLETE DROP IN SYSTEM.

Simply excavate and drop in! Designed to increase productivity of installation and down time. System includes all components required:

- Bollards and Frame (1-5 Bollards) per frame
- Completely pre-fabricated top and bottom cage
- Sump Pump and pre-fabricated drainage system
- Pre-wired/connected pneumatic, electrical and drainage connections
- Conduit provisions for safety loops and access control
- All connections routed to a Point of Attachment.
- Cage stands and installation jigs
- Lifting points

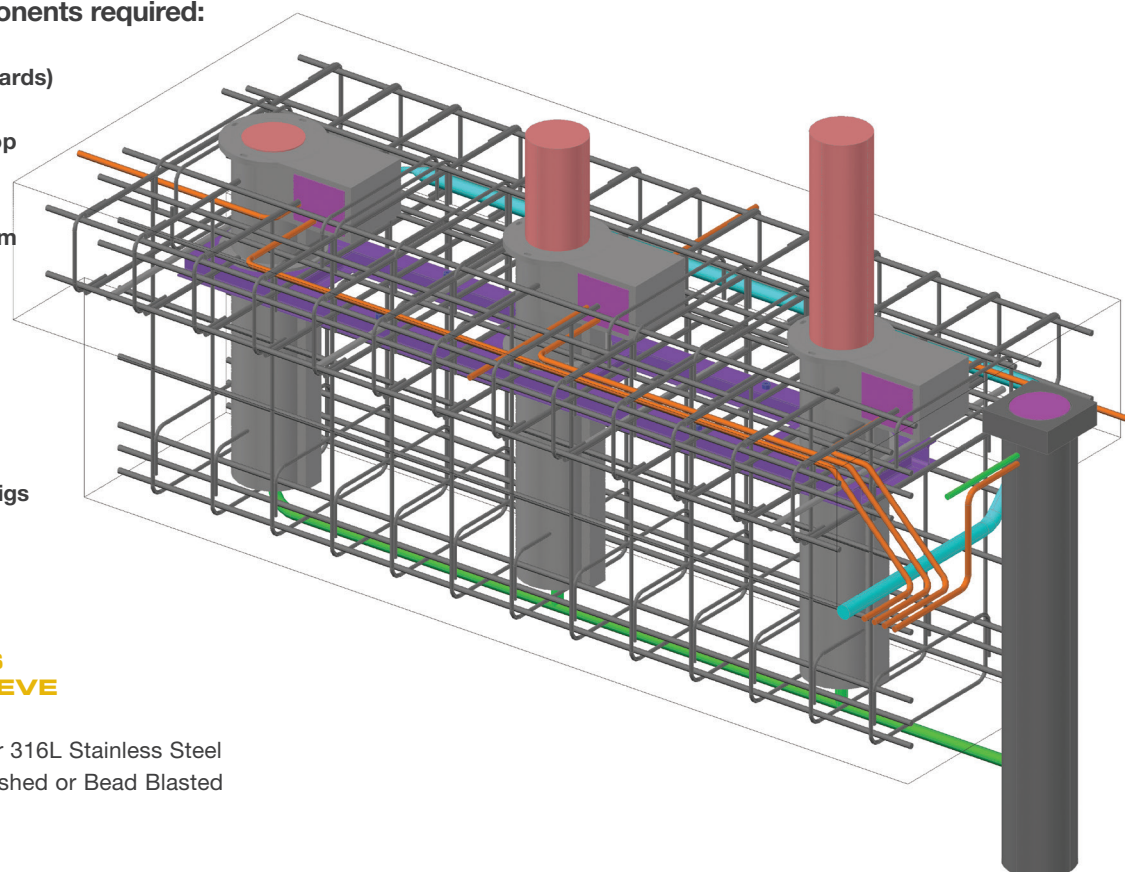

### STAINLESS STEEL SLEEVE

**Material:** 304 or 316L Stainless Steel  
**Treatment:** Polished or Bead Blasted

## OPTIONS

- Range of RAL Colours – Anti-corrosion protection with high zinc powder coating
- 304 or 316L Stainless Steel Sleeve
- Reflective band
- Emergency operation that over-rides the safety procedures
- Bollard movement Siren/Flasher
- Additional Safety and Control Loop Detection
- Traffic Signals
- Boom Gates and Access Control
- High Level Interface
- Antifreeze system down to -50°C

## SPECIFICATIONS

**Dimensions (mm):** Ø275 Height = 900mm  
**Material:** High-resistance steel  
**Treatment:** Heat galvanized body (casing and bollard head)  
**Cylinder:** Manual Assisted, Pneumatic, Hydraulic, or Electro-mechanical  
**Standard operating temperature:** from 0 to 50 °C  
**Extracting time:** from 2 to 4 seconds  
**Retracting time:** 2 to 4 seconds  
**Protection rating:** IP67 (sealed against dust and protected from any immersion effects)  
**Total weight:** 630 kg per Bollard



**OZTIME TECHNOLOGIES**  
138 Fairey Road, South Windsor NSW 2756  
PH: 02 4577 5292 [www.oztime.com.au](http://www.oztime.com.au)



**WORLD'S LEADING HIGH SECURITY RETRACTABLE BOLLARD SYSTEM**  
**SECURE - SOLID - SAFE**



# OZTIME TECHNOLOGIES

## PAS68 RATED HIGH SECURITY AUTOMATIC RETRACTABLE BOLLARDS

Oztime's PDT1200 retractable bollard blends aesthetics with the highest level of perimeter security. The PDT1200 bollard system is powered by a pneumatic compressor which is fast, efficient, and environmentally-friendly. All components are cycle-tested, and the system requires little maintenance. The PDT1200 PAS68 and ASTM rated bollard system reacts quickly. Variable speed settings can quickly lift the bollards in seconds in an emergency. In addition to standard commands, the customisable control system can allow for virtually any desired control input or output, sequencing or procedure, including specific requests such as, Panic Up or Emergency Down. The system operates smoothly even in extreme temperatures. Engineered wiper seals reduce the amount of water and grime that enters the bollard's recess. The PDT1200 system is available in a range of lifting devices including Pneumatic, Hydraulic, Electromechanical and Manual Assisted Lift. Choose from a myriad of powder coat colours which comes standard for all carbon steel bollards. We also offer stainless steel bollard covers for different architectural finishes. Combine PAS68 automatic retractable bollards with PAS68



embedded bollards for a more economical perimeter defence that doesn't sacrifice protection. Consider deploying PAS68 manual assisted lift bollards where high duty cycles aren't required or power isn't available.

## PAS68 RATED HIGH SECURITY MANUAL ASSISTED LIFT RETRACTABLE BOLLARDS

The Oztime PDT1200M Manual Assisted Bollard is the Only PAS68 rated Vertical Lift Manual Bollard in the world. Certification: Rising Bollard impact to PAS68:2010 V/7500(N3)/80/90:7.1/0.0 Manual assisted-lift retractable bollards incorporate a self-contained pneumatic system to assist the rise of the bollard into place. This pneumatic lift facilitates ease of deployment. It allows for a heavier, more secure bollard to be operated manually. With the turn of a key, manually

assisted bollards easily rise from the ground and can be locked into place. Turn the key again, and with very little effort, the bollard cylinder retracts and locks flush to the ground surface. Appropriate for high and medium security installations where occasional vehicular traffic must be blocked or allowed access. The retractable assisted-lift security bollard will dependably operate in very harsh conditions with limited maintenance and can be operated occasionally to frequently.



### PDT 1200 SERIES BOLLARD SYSTEM



MIRA K0069

- Completed successful crash test and received the V/7500(N3)/80/90:7.1/0.0 certification from MIRA testing facility, England.
- Flexibility in choice of lifting mechanisms.
- Decorative or standard Bollard Heads available.
- Bollard functional and operational after crash test.

Rapid Deployment Protection Systems consist of any number of bollards that deploy quickly, stop brutal attacks and still operate. These revolutionary systems answer the need for both uncompromising protection and design flexibility.

